



# **ST. ANNE**

# **TEMPORARY RELOCATION PLAN**

---

Community Open House and Information Meeting  
St. Anne Catholic Elementary School

December 7, 2022

# Agenda

- Welcome – Ms. Rossi, Principal, St. Anne
- Opening Prayer
- Land Acknowledgment
- Introductions
- Presentation by planning department
- Open House Q&A

# Opening Prayer

Gracious and merciful God of all creation,

During this Season of Hope,  
we remember how you sent Your Son  
to be the beacon of goodness and  
light in the world.

Give us eyes of hope to see the  
good in everything  
and everyone around us.

Amen

# Land Acknowledgement

We begin by acknowledging the land and our responsibility to care for and respect all that Creation gives to provide us with life. This land upon which we live, work and sustain ourselves is the ancestral and treaty lands of the Michizaagiig Anishinaabek also known today as the Mississaugas of the Credit, the rightful caretakers and titleholders of this land. We also recognize that this land is rich in pre-contact history and relationships, which includes the Anishinaabek and Onkwehonwe and since European contact has and continues to become home for Indigenous and non-Indigenous peoples.

# Land Acknowledgement

As a responsible community we believe all people are sacred and possess inherent and immeasurable worth and dignity.

Colonialism displaced and dispossessed Indigenous Peoples of their ancestral lands and continues to deny their basic human rights, dignities and freedoms. We are committed to the sacrament of reconciliation, making reparations and fulfilling our treaty obligations, duties and responsibilities as outlined in the Gdoo-naaganinaa (Dish with One Spoon) wampum. This treaty governs and affirms that we actively maintain mutually beneficial relationships and collectively respect and care for the land, water, animals and each other in order to guarantee a good life for our future descendants.

# DPCDSB Staff

- Tammy-Lynne Peel - Superintendent, Family of Schools
- Mathew Thomas - Superintendent of Planning and Operations
- Laura Rossi - Principal, St. Anne
- Maria Vitale – Vice Principal, St. Anne
- Stephanie Cox - Manager of Planning
- Joanne Rogers - Senior Planner
- Krystina Koops - Planner
- Megha Dhawan - GIS Planner

# Why are students being relocated?

- Ministry has approved our capital project to rebuild St. Anne
- Existing building will be demolished
- Safety of staff and students
- Size and configuration of the site is not suitable to build the school on another part of the site while the school remains operational
- Insufficient access of construction vehicles and storage of materials, lack of parking for staff, no play space for students

# St. Anne Enrolment

- Current Enrolment: **486 students**
- **10** students in remote classes

| Program         | # Students | # Required Classrooms |
|-----------------|------------|-----------------------|
| Regular Track   | 333        | 15                    |
| Extended French | 143        | 6                     |
| Total           | 476        | 21                    |



# Options Considered

- Relocate entire school to a closed elementary school in Central Mississauga
  
- Host school by program
  - *regular track at one location and extended French at another location*
  
- Host school by grade
  - *FDK to grade 3 at one location and grade 4 to 8 at another location*

# Option Considerations

- Available classroom space
- Available kindergarten space
- Proximity to St. Anne
- Kiss 'n ride to accommodate additional busses
  
- St. Anne will continue to operate as St. Anne CES, with their own staff, teachers, and administration and separate start/end times from the host school

# Preferred Option – Host School by Program

Regular Track students K- Gr.8

- *Hosted at St. Ursula CES*

Extended French students Gr.5 – Gr.8

- *Hosted at St. Angela Merici CES*

*Remote Students will not be affected*

# Preferred Option – Host School by Program

## St. Ursula:

- *Available classrooms = 15*
- *Available FDK rooms = 2*

## St. Angela Merici:

- *Available rooms = 8*

# Host School Locations



Dufferin-Peel  
Catholic District  
School Board

## ST. ANNE RELOCATION PLAN

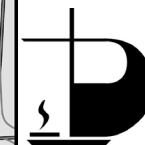
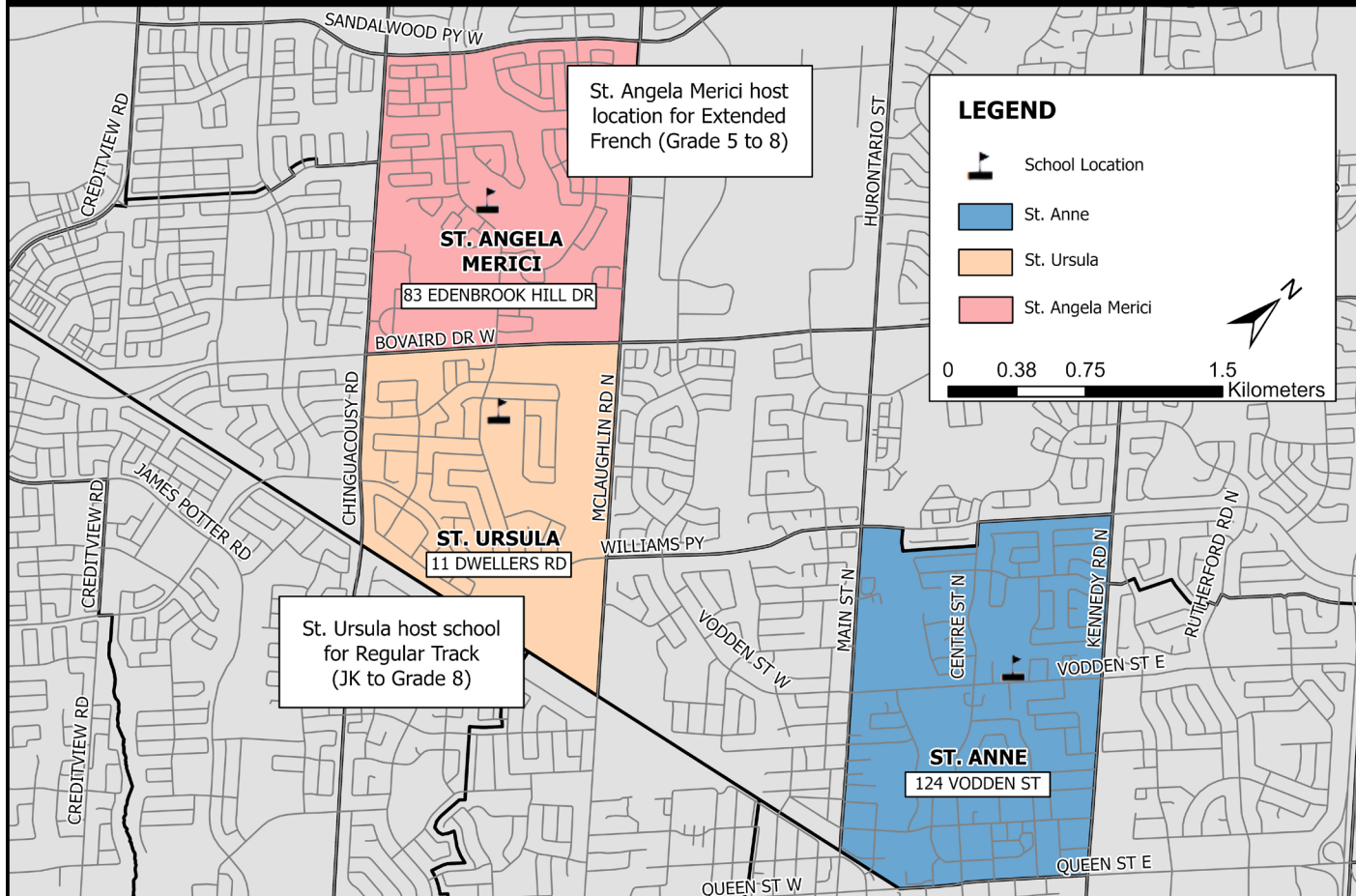

Dufferin-Peel  
Catholic District  
School Board

# School Hours

St. Anne current bell time

- ***9:00 am to 3:30 pm***

Regular Track K- Gr. 8 Hosted at St. Ursula

- ***NEW bell time 8:40 am to 3:10 pm***

Extended French Hosted at St. Angela Merici

- ***NEW bell time 8:45 am to 3:15 pm***

# Before and After School Program (BASP) & Transportation

- BASP at St. Ursula – PLASP
- BASP at St. Angela Merici – YMCA
- Transportation to host locations will be provided to all eligible students

# Design

New 504 pupil place school

- 4 FDK rooms
- 17 classroom
- 1 special education room

New kiss'n ride and parking area



# Site Plan



DEVELOPMENT DETAILS:

# Rendering

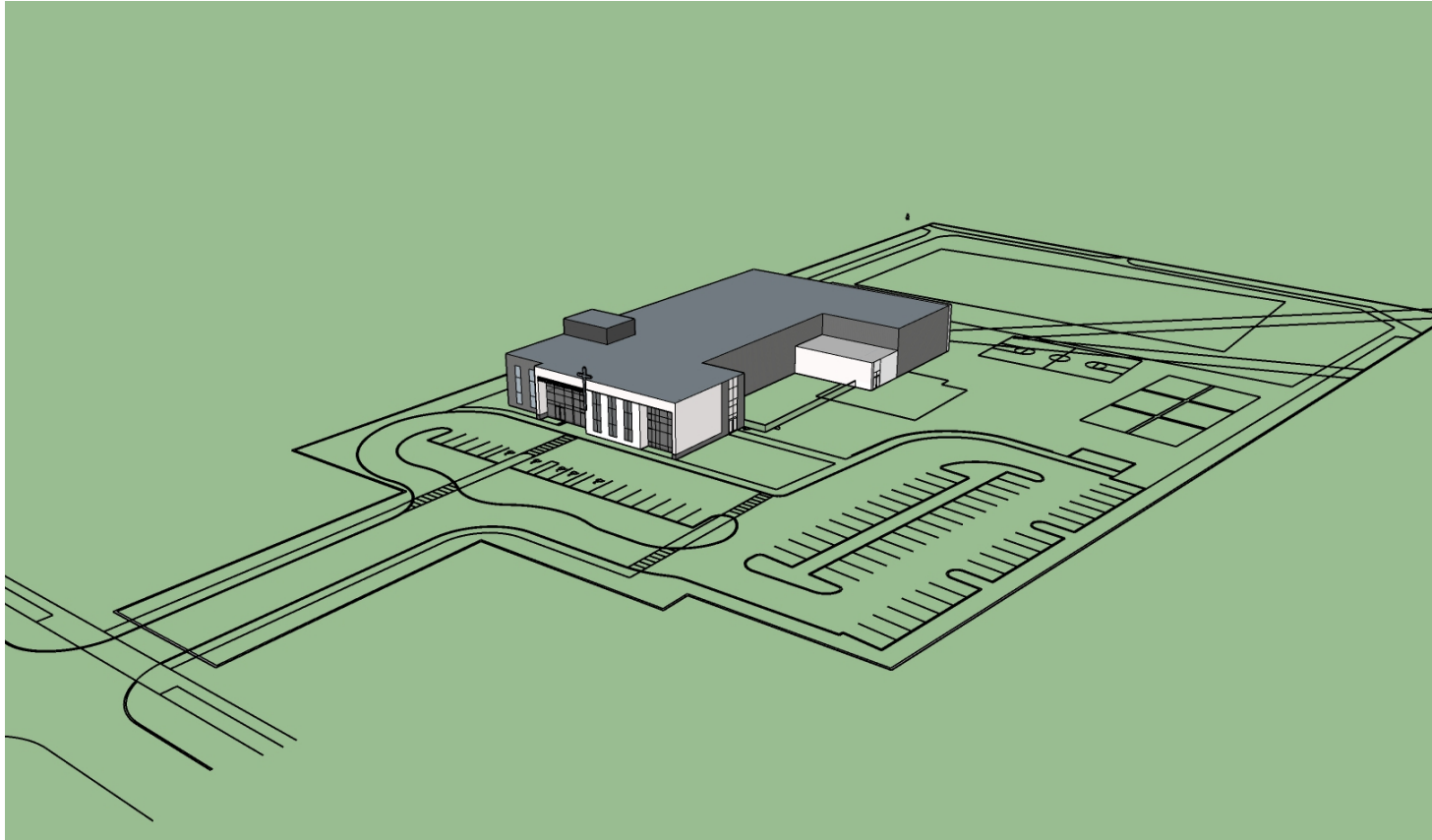

# Rendering

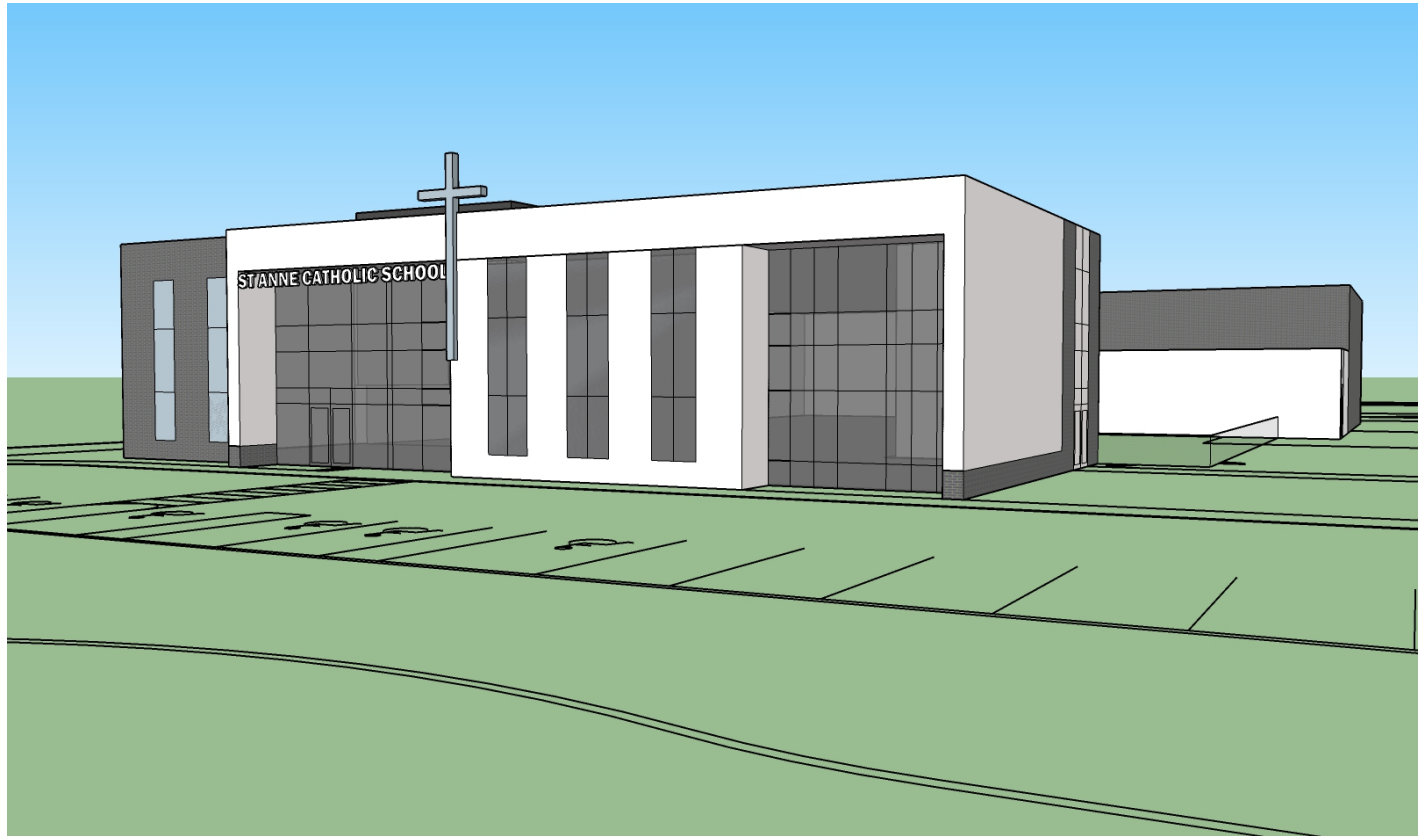

# First Floor



- FINISH
- WALL
- FLOOR
- CEILING
- MECHANICAL
- ELECTRICAL
- PLUMBING
- HVAC
- STAIRS
- ELEVATORS
- EXTERIOR
- INTERIOR
- FURNITURE
- EQUIPMENT
- SIGNAGE
- LIGHTING
- SECURITY
- ACCESSIBILITY
- SUSTAINABILITY
- SMART BUILDING
- WELLNESS
- COMMUNITY
- EDUCATION
- RESEARCH
- INNOVATION
- COLLABORATION
- LEARNING
- GROWTH
- CHANGE
- IMPROVEMENT
- OPTIMIZATION
- EFFICIENCY
- EFFECTIVENESS
- RESILIENCE
- ADAPTABILITY
- FLEXIBILITY
- SCALABILITY
- SECURITY
- COMPLIANCE
- QUALITY
- VALUE
- IMPACT
- LEGACY

MAIN ENTRANCE

- LEGEND**
- CLASSROOMS
  - COLLABORATION
  - KINDERGARTENS
  - SPEC. CLASSROOM
  - GYMNASIUM WING
  - LEARNING COMMONS
  - ADMIN & STAFF AREAS
  - WASHROOMS
  - STORAGE
  - MECH / ELEC / CUSTODIAL





# Next Steps:

- Students to be relocated beginning September 2023
- St. Anne will be vacated end of June 2023
- Any changes to timelines and/or status of the project will be communicated through future ***Community Information Bulletins***

# Questions?